

# CUTTING-EDGE CONFERENCING IN THE NATIONAL CAPITAL

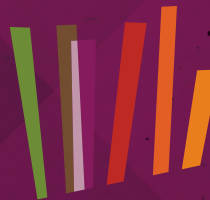

NATIONAL  
CONVENTION  
CENTRE **Canberra**



**GET IN TOUCH  
CHECK AVAILABILITY  
AND RATES**

[nccc.com.au](http://nccc.com.au)

New Look - Flexible Space - Attentive Service - Award Winning Food



Managed by InterContinental Hotels Group (IHG), the National Convention Centre is Canberra's leading meetings and events venue; unrivalled in facilities, size and scope. The Centre is equipped to handle events of all sizes, from small groups and breakout meetings to conferences for up to 2,400 delegates and exhibitions.

Crowne Plaza Canberra, a mere 150m from the National Convention Centre Canberra, serves as host accommodation hotel for delegates and VIP's alike.

The hotel has a variety of meeting space and venues suitable for committee meetings, secretariat space, additional breakout rooms, executive meetings or intimate social gatherings.

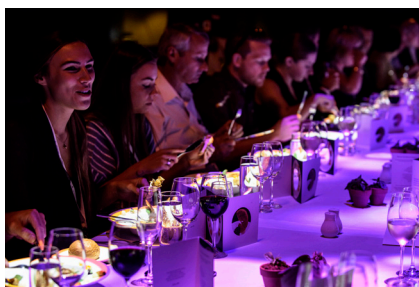

### VERSATILITY AND EXCLUSIVE USE

With a collection of more than 15 spaces over two floors, the Centre features a compact and logical design with abundant natural light taking advantage of Canberra's clear skies and sunlight.

### LOCATION

The Centre is located in the heart of the Central Business District. A short 7km drive from the airport, walking distance to Canberra's largest shopping precinct, restaurants and bars, a variety of accommodation and easy access to Canberra's national treasures, including Australia's Parliament House, National Gallery of Australia and the Australian War Memorial.

### AWARD WINNING CENTRE

The National Convention Centre is an award winning Centre. From sustainability, special events and outstanding team members, the Centre has an array of awards to celebrate.

### DIGITAL CONNECTIVITY

In an increasingly connected world, the demand for business professionals to be accessible wherever they are is paramount. Recognising this trend, the National Convention Centre provides complimentary Wi-Fi for all delegates for email and website browsing and offers the best connectivity in Canberra for your meeting content.

### FACILITIES

#### ROYAL THEATRE

The Royal Theatre is the perfect venue for conferencing and entertainment. Standout features include tiered new seating and a flat floor section in front of the large stage, backstage support rooms and an audio visual control room. Numerous configurations are possible and the flexibility of this venue, including vehicle access to the flat floor sections, makes it a favourite with meeting planners and delegates alike.

#### THEATRETTES

The Centre features four Theatrettes varying in size that accommodate up to 287 people. The newly refurbished Theatrettes feature excellent lines of sight, in-built data projectors, screens, and PA systems.

#### BALLROOM

The Ballroom is one of Canberra's largest. It features natural light, a 4.5m high ceiling and 658m<sup>2</sup> of pillar less space. This is the perfect venue for meetings, functions, cocktail events and gala dinners.

#### EXHIBITION HALL

The Exhibition Hall is a spacious and versatile setting for large scale exhibitions, gala dinners, cocktail parties, award ceremonies and is the most adaptable space for special events in Canberra. The 2000m<sup>2</sup> Exhibition Hall can hold up to 120 exhibitor booths and has a ceiling height of 9m with a vehicle access height of 3.9m. Full length windows overlooking Glebe Park provide an abundance of natural light.

#### GALLERY ROOMS

The Gallery Rooms present the ideal space for intimate gala dinners and events. The five rooms all have natural light with comfortable seating and are perfect for small-scale events including meetings, seminars and exhibitions. They can be used individually, or combined to create larger spaces, providing flexible options for your event.

# ROOM CAPACITIES

Room	Area (m2)	Ceiling Height (m)	Booths (3x3m)	Theatre	Cocktails	Banquet	Dinner Dance	Cabaret	Classroom	Boardroom	U Shape	Hollow Square
<b>Exhibition Hall</b>												
Exhibition Hall (Total)	2000	9.0	120	1775	1775	1500	1400	1200	1000	—	—	—

<b>Royal Theatre</b>												
Royal Theatre (Total)	—	9.1	—	2448	—	—	—	—	—	—	—	—
Royal Theatre (Tiered)	—	4.6–9.1	—	1698	—	—	—	—	—	—	—	—
Royal Theatre (Flat floor)	749	9.1	—	780	1000	540	470	432	400	—	—	—

<b>Theatrettes</b>												
Bradman	360	3.2–4.4	—	287	—	—	—	—	—	—	—	—
Menzies	180	3.2–4.4	—	172	—	—	—	—	—	—	—	—
Nicholls	180	3.2–4.4	—	158	—	—	—	—	—	—	—	—
Sutherland	170	3.2–4.4	—	141	—	—	—	—	—	—	—	—

<b>Flat Floor Function Rooms</b>												
Ballroom (Closed)	658	4.5	30	500	500	500	440	360	370	—	96	108
Ballroom (Open)	762	4.5	30	—	650	580	520	—	—	—	—	—

<b>Gallery Rooms (Individual)</b>												
Torrens Room (T)	90	3.3	5	80	80	60	—	48	36	24	30	36
Swan Room (S)	155	3.3	10	140	140	80	80	64	48	36	30	36
Murray (M)	170	3.3	10	170	170	120	100	96	72	42	48	60
Fitzroy (F)	170	3.3	10	170	170	120	100	96	72	42	48	60
Derwent Room (D)	95	3.3	5	80	80	60	—	48	36	24	30	36

<b>Gallery Rooms (Combined)</b>												
TS Rooms	245	3.3	15	200	200	150	130	120	96	48	54	66
MF Rooms	340	3.3	20	368	368	240	210	192	156	—	84	104
FD Rooms	265	3.3	15	256	256	180	150	144	120	—	72	88
MFD Rooms	435	3.3	25	—	512	330	270	—	—	—	—	—

<b>Work Rooms</b>												
Boardroom 1	27	2.6	—	20	—	—	—	—	—	12	—	—
Boardroom 2	24	2.6	—	20	—	—	—	—	—	12	—	—
Executive Room	90	2.7	—	60	60	50	—	32	40	24	25	30

<b>Foyer Areas</b>												
Main Foyer	1100	3.4	—	—	800	—	—	—	—	—	—	—
Theatrette Foyer	400	3.8	—	—	200	—	—	—	—	—	—	—
Ballroom Foyer	300	5.3	—	—	200	—	—	—	—	—	—	—
Gallery Foyer	390	4.1	—	—	250	—	—	—	—	—	—	—

Royal Theatre - Concerts	Area (m <sup>2</sup> )	Ceiling Height	Booths	Tiered/ Theatre	General Admission (GA)	Flat floor seating	Total
Royal Theatre (Tiered + GA)	—	9.1	—	1698	1680	—	3378
Royal Theatre (Tiered + Flat Floor Seating)	—	4.6–9.1	—	1698	—	780	2478
Royal Theatre (GA on Flat floor)	749	9.1	—	—	2000	—	2000
Royal Theatre (Tiered + GA on Flat Floor)	—	4.6–9.1	—	1378	2000	—	3378

Please note: Capacity numbers listed are indicative only. Wheelchair accessibility has been included in capacity chart numbers listed.

The National Convention Centre Canberra is the perfect events venue, boasting premium facilities for every occasion.

Contact our Events Team on **(02) 6276 5200** or visit us online at [nccc.com.au](http://nccc.com.au)

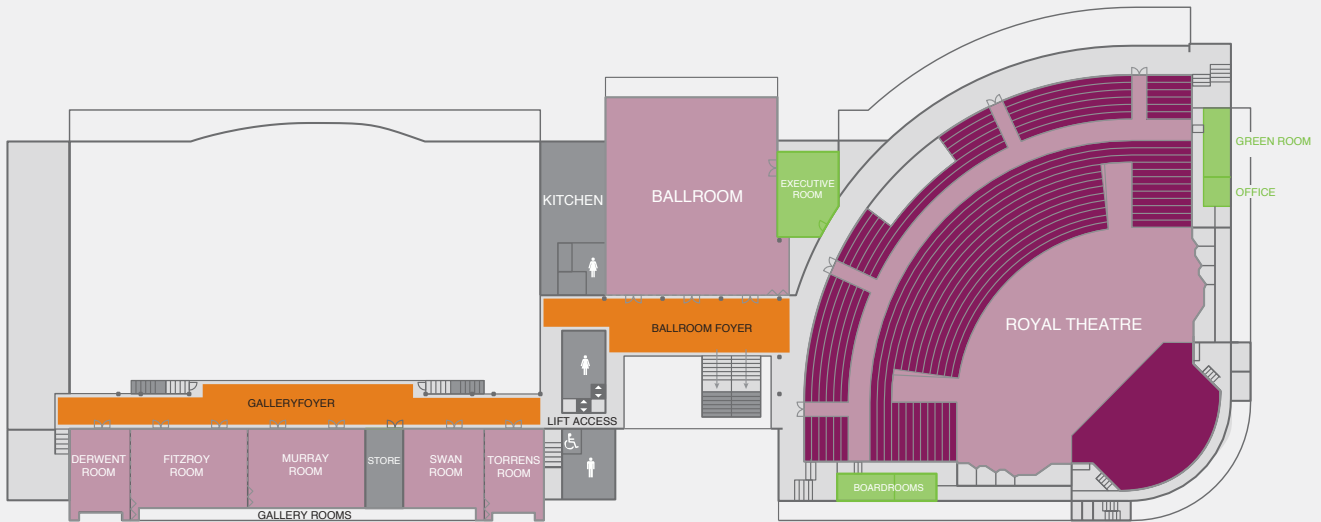

**FIRST FLOOR**

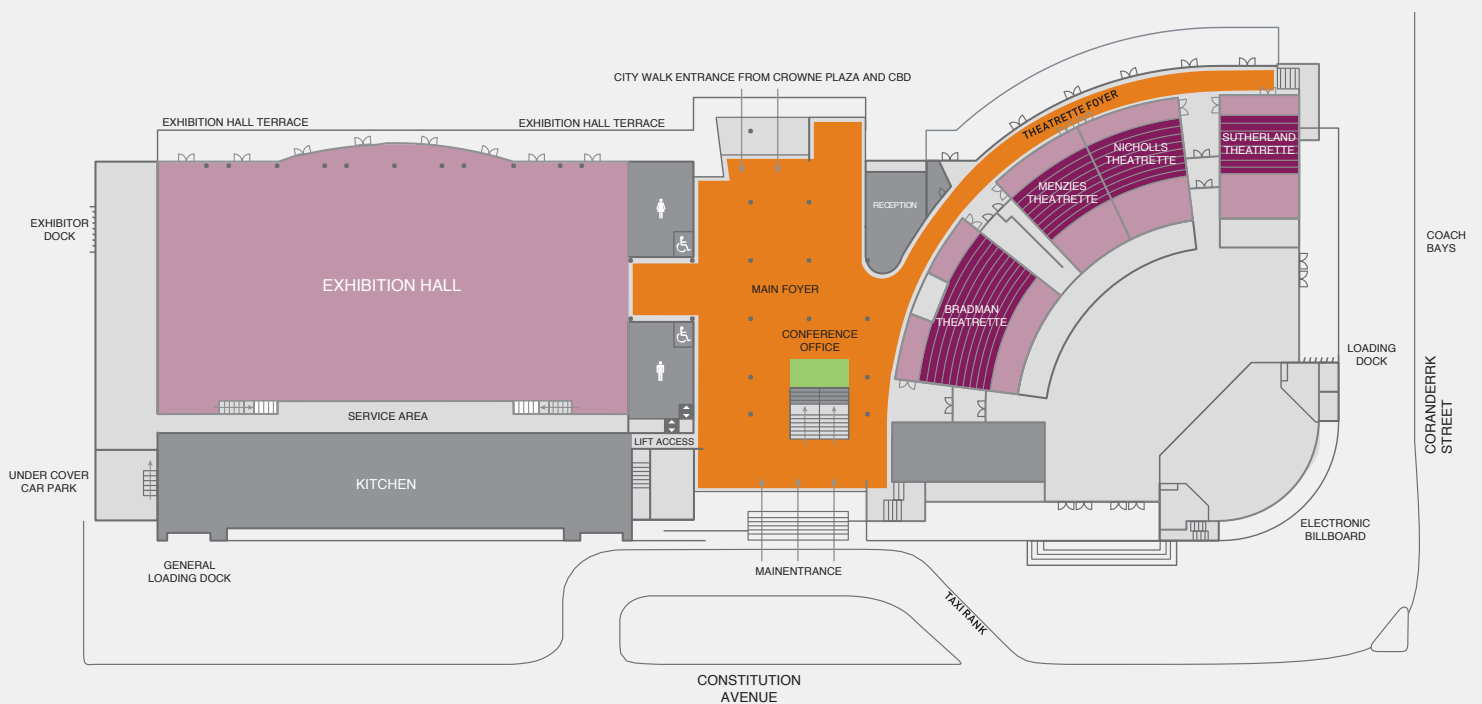

**GROUND FLOOR**

**KEY** MEETING AND EXHIBITION SPACES WORK ROOMS FACILITIES FOYER

A 31 Constitution Ave, Canberra ACT 2601  
 P PO Box 1013 Civic Square ACT 2608  
 T +61 2 6276 5200 E [nccc.sales@ihg.com](mailto:nccc.sales@ihg.com) W [nccc.com.au](http://nccc.com.au)

